

# Battery-Powered Outdoor Security Camera

**4K**

Ultra HD

Live View

**Tapo C460**

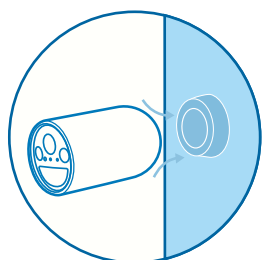

Adjustable  
Magnetic Base

**SONORA**  
PROFESSIONAL  
SERVICES  
INTÉGRATION  
AUDIOVISUELLE



**Cord-Free with 10,000mAh Rechargeable Battery**

Starlight Color  
Night Vision

Free Person/Pet/  
Vehicle Detection

Weatherproof  
Certified

Free Local microSD  
Storage (Up to 512 GB)\*

works with **amazon alexa**

works with **Google Home**

## // Highlight

### 4K Crystal Clear Surveillance

Capture every detail with precision. Tapo C460 features 4K resolution and 18x digital zoom for superior clarity. See more. See clearer. Stay secure.



### Go Magnetic, Snap Anywhere!

This battery Wi-Fi camera offers 100% wire-free installation with a magnetic base, allowing for easy placement and rotation at any angle, without the need to screw it into the camera bracket.



## // Highlight

### Premium Features. Total Control. All in One App.

Secure and control your home anywhere, anytime with the Tapo app. View live footage, speak to visitors, share clips, and easily tailor advanced settings.



#### Free Person/Pet/Vehicle Detection

Identifies people, pets, and vehicles while only sending you alerts when truly needed.



#### Customizable Activity Zones

Set up customized detection zones to be alerted only in areas where you wish to monitor and block out zones you want hidden.



#### Anti-Theft Alert & Privacy Lock

Get notified instantly if your camera is removed by an intruder. Secure your microSD card with a password via the Tapo app for enhanced privacy protection.

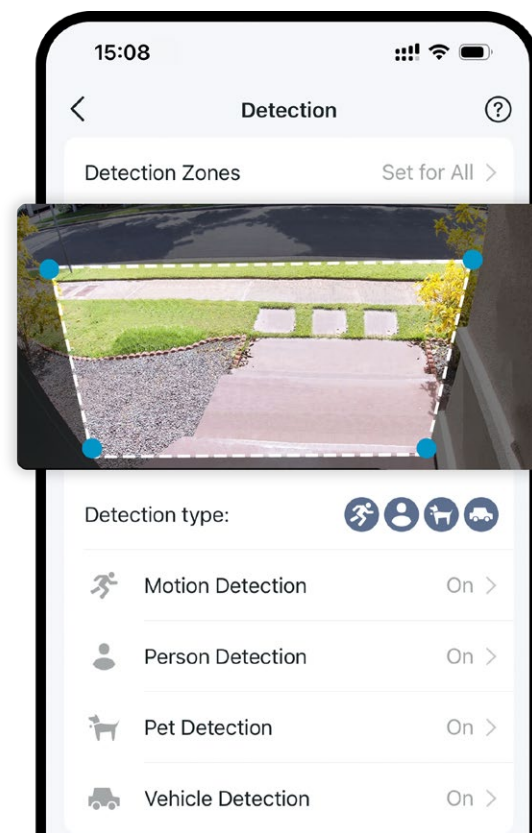

## // Features



### 4K Crystal-Clear Surveillance

Capture every detail with precision. Tapo C460 features 4K resolution and 18× digital zoom for superior clarity. See more. See clearer. Stay secure.



### Starlight Color Night Vision

Enhances your security by revealing brighter, full-color images and vivid details even in low-light conditions with built-in spotlights and the starlight sensor.



### 10000mAh Rechargeable Battery

The built-in 10,000mAh rechargeable battery ensures extended usage, providing long-lasting power.



### Connect Directly to Wi-Fi

Easily connect the camera to your network wirelessly via Wi-Fi for a more flexible installation.



### Two-Way Audio

Talk and listen through the device with its integrated microphone and speaker.



### Local and Cloud Storage

Store footage on a microSD card (up to 512 GB)<sup>†</sup> with no subscription required, or opt for cloud storage<sup>§</sup> with a 30-day free trial for added convenience.



### IP66 Weatherproof

Performs well even in harsh environments with rain and dust, ideal for outdoor scenarios.



### Customizable Sound and Light Alarm

Record your voice and set the spotlight brightness to create an alarm that fits your needs.



### Optional Solar Panel

Enjoy a maintenance-free security experience with the Tapo Solar Panel, which provides a continuous power supply.<sup>^</sup>



### Voice-Activated View

Seamlessly integrates with Amazon Alexa and Google Assistant for hands-free control and convenient check-ins.\*

## // Specifications

Camera	Image Sensor	1/2.7" Progressive Scan CMOS Starlight Sensor
	Lens	Focal Length:3.17mm Aperture: F1.65 Field of View: 134° (Diagonal), 113° (Horizontal), 59° (Vertical)
	Night Vision	4× 850 nm IR LEDs (49 ft / 14.9 m) Starlight Color Night Vision
	Night Mode	IR-Mode/ Full-Color Mode
	Day/Night Switch	IR-Cut Filter with Auto-Switching
	Lighting	2× Built-in Spotlights Motion Activated, App-Controlled
	Interface & Button	1× POWER Button 1× RESET Button 1× microSD Card Slot (Up to 512 GB)
Video & Audio	Maximum Resolution	4K 8MP (3840 × 2160 px)
	Frame Rate	15fps
	Video Compression	H.265 / H.264
	Live View	Yes
	Image Enhancement	3DNR WDR

Video & Audio	Audio Input & Output	Built-in Microphone and Speaker
	Audio Communication	Two-Way Audio with Noise Cancellation
	Siren Volume	100 dBA (Level measured at 10cm distance) 80 dBA (Level measured at 100cm distance)
Storage	Local Storage	microSD Card Slot on Camera (Up to 512 GB) (SD Card Purchased Separately)
	Cloud Storage	Tapo Care Cloud Storage Services (Subscription required)
Detection & Notification	Sensor	Single Motion Sensor (FOV: 120° horizontal) Single Ambient Light Sensors
	Detection	Motion Detection Person Detection Pet Detection Vehicle Detection
	Activity Zones	Yes
	Output Notification	System Notification System Notification with Snapshot (Tapo Care Services)
Network	Network Connectivity	Connect via Wi-Fi
	Wireless Connectivity	IEEE 802.11b/g/n, 2.4 GHz Wi-Fi IEEE 802.11a/n, 5 GHz Wi-Fi
	Transmission Rate	11b: 11 Mbps 11g: 54 Mbps 11n: 72.2 Mbps 11a: 54 Mbps
	Protocol	TCP/IP, ICMP, DNS, HTTPS, TCP, UDP

Security	Security	128-bit AES Encryption with SSL/TLS WPA/WPA2-PSK
Power	Power Source	Built-in Rechargeable Lithium-ion Battery Work with Tapo A201 Solar Panel (Purchased Separately)
	Camera Adapter Input	100-240 V, 50/60 Hz (Not included)
	Camera Adapter Output	5.0 V, 2.0 A (Not included)
	Power Cord Length	USB Adapter Cable Length: 0.5 m (19.68 in.)
	Camera Typical Power Consumption	0.983 W
	Camera Maximum Power Consumption	3.797 W
General	Certifications	CE, FCC, DOE, CEC, RCM, KC, NCC, BSMI, NTRA, IP66
	Smart Integration	Google Assistant, Amazon Alexa
	Weather Resistance	IP66
	Mounting Options	Ceiling-Mounted, Wall-Mounted
	Operating Temperature	-20°C ~ 45°C (-4 °F ~ 113 °F )
	Storage Temperature	-40°C ~ 60°C (-40 °F ~ 140 °F )
	Operating Humidity	10%~90% RH, Non-condensing
	Storage Humidity	5%~90% RH, Non-condensing
	Charging Temperature	0°C ~ 45°C (32 °F ~ 113 °F )

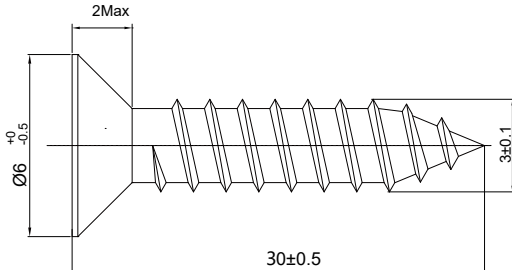
General	Dimensions	D64.8 x 114.6 mm (D2.55 x 4.51 in.)
	Weight	11.53 oz / 327 g
	Screw Size	 <p>Unit: mm</p>
	Package Contents	Tapo C460 Camera ×1 Metal Plate ×1 Magnetic Base ×1 USB Adapter Cable ×1 Mounting Screws ×6 Mounting Anchors ×6 Camera Bracket ×1 Mounting Templates ×2 Quick Start Guide



## // Appearance

### Front

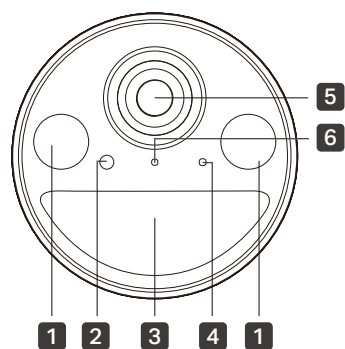

- 1** Spotlights
- 2** Light Sensor
- 3** Motion Sensor
- 4** Microphone
- 5** Lens
- 6** Status LED

### Side

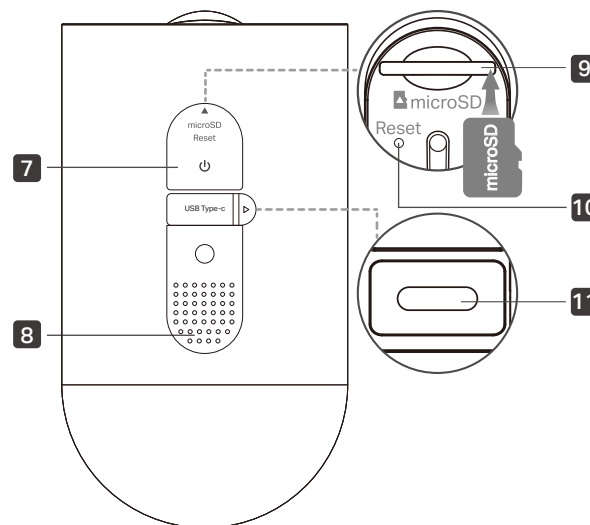

- 7** **Power Button**   
Press and hold for about 3 seconds to turn on/off the camera.
- 8** **Speaker**
- 9** **microSD Card Slot**  
Open the cover. Insert a microSD card\* and initialize it on the Tapo app for local recording.  
\*microSD card not included.
- 10** **Reset Button**  
Press and hold for **5s**: Reset Wi-Fi while keep other settings.  
Press and hold for **10s**: Reset to factory settings.
- 11** **USB Type-C Charging Port**  
Open the cover for USB charging.

**SONORA**  
PROFESSIONAL  
SERVICES

INTÉGRATION  
AUDIOVISUELLE

\*microSD card purchased separately. Actual storage capacity depends on the size of the microSD card used.

‡Subscribe for cloud storage at <https://www.tapo.com/tapocare/>

\*Tapo solar panel purchased separately. Actual experience may vary due to placement angle, weather conditions, and camera usage.

\*Compatible with Alexa and Google Assistant supported displays. User experience is dependent on the connected device's specifications.

Specifications are subject to change without notice. All brands and product names are trademarks or registered trademarks of their respective holders.

©2025 TP-Link